



KONICA MINOLTA

bizhub

306i / 266i

A3



306i BW **30** PPM

266i BW **26** PPM

Giving Shape to Ideas



READY TO WORK

SIMPLE SECURE CONVENIENT

With the new generation of bizhub, Konica Minolta are rethinking the way multifunctional devices work for your business. Ideal as either a stand-alone device, or as part of a larger network of bizhub machines, the compact 306i series lets you get things done the simple, secure and convenient way.

SIMPLE

Don't get lost in settings. With the same user interface across all new generation bizhub machines, the 306i series will guide you quickly through every process.

7-inch Touch Panel & New User Interface

Control your bizhub from a large, multi-touch panel. Featuring full colour and seamless operation, you will feel familiar from the first touch thanks to an intuitive, smartphone-like user interface.



Easy to Use

Less Steps to Get What You Need

Konica Minolta's next-generation user interface is designed to help you complete tasks in as few steps as possible. Icons and colours are easy to digest, and the touch screen guides you to your final destination in just a few taps.

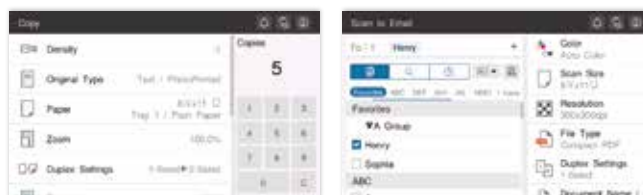
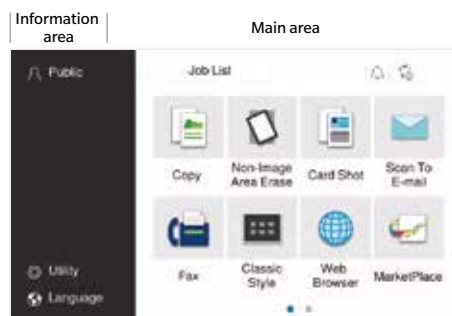

Optional Hard-key Number Pad

A hard-key pad with numbers and simple operation keys can be added to your bizhub as an option, for those who aren't comfortable with touch panel operation.



Mobile-like Operability

Intuitive operation makes using your bizhub as easy as navigating your smartphone. Use scrolling and flicks to get around just like you do on your tablet or other familiar touchscreen devices.



Customize Your Touch Panel

Save time wrestling with settings every time you Copy or Fax by entering default settings from their respective mode screens. Complete the settings once, and get the job done faster next time.

The User Interface that Fits

Select from a range of display styles to suit your purpose. If you only need to perform normal routine work, select the Basic Style. Or choose the Classic Style for a more settings-rich interface.

Basic Style

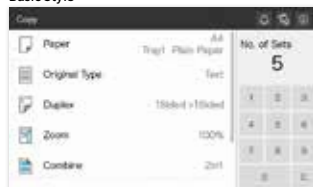

Classic Style



On-screen Visual Support

If you run into problems while operating your bizhub, such as paper jams or consumables needing replenished, helpful on-screen prompts will direct you to the source of the problem and give visual pointers on how to quickly resolve the issue.



SECURE

Security doesn't need to slow you down. From virus scanning to user authentication, keep your data safe with a range of security features.

Virus Scan by Bitdefender

Keep your data safe from viruses with real-time virus scanning by Bitdefender. Choose between real time scanning or specify a regular timed scan. When a threat is detected, it will be automatically deleted, protecting your bizhub from downtime and lost data.

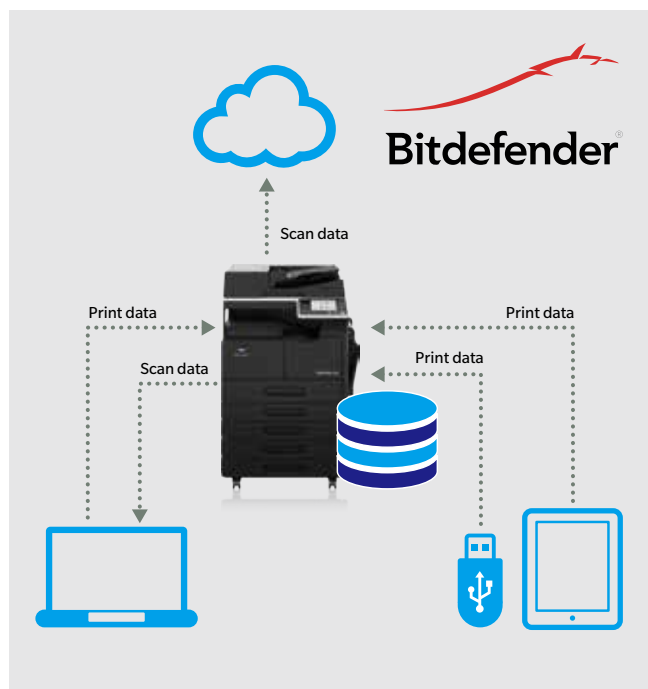

Virus scan is optional

User Identification

ID & Print

When this mode is activated, users identify themselves to the bizhub by inputting their user information at the base unit, ensuring documents won't fall into the wrong hands. With this function, print settings can be changed via the control panel even after you send the print job to the unit.

ID Card Authentication

Use an ID card to access your bizhub, allowing for quick, fuss-free use that nevertheless maintains your office security.

ID Card Authentication is optional



Tap to Connect Android or iOS Devices

Print directly from mobile devices via Wi-Fi with the Konica Minolta Mobile Print app. Skip extra steps getting your documents to the printer and simply tap your NFC (Near Field Communication) enabled device on the pad to the right of the control panel to connect, or connect via Bluetooth*.



*Optional device connection I/F kit EK-613 required. Bluetooth LE (low energy) required for iOS devices. Wireless LAN environment required. Konica Minolta Mobile Print is available free from the App Store for iOS devices and the Google play for Android devices.

Keep Your Office Network Safe with Enhanced Security Modes

With the new Wireless LAN module, you can now set security modes from the master unit. The Realtek RTL8812 module allows for MAC address filtering, any-to-any connectivity and automatic passphrase update security functions, so you can move data around your office without the risk of data loss or external threats.

Vital Security All in One Place

Avoid serious gaps in your security by checking the Quick Security menu. Here you will find all the security items we recommend you set when your machine is installed, all together in one place.



- Administrator password
- Password rules
- Web Connection setting
- Security Warning Display Setting
- USB Connection Settings

Only available in Classic Style

Next Generation Security

Comes with the highest security standards built-in.

Compatible with HTTP/2 over TLS

You can now use the newer HTTP/2 network protocol with your bizhub, enabling improved connectivity to the Internet and the cloud. With HTTP/2, multiple requests and responses can be processed via a single TPS connection, and mandatory encryption of all communication make it much more secure when operating on the Web.

bizhub SECURE Services

With our bizhub SECURE services, we tailor the security settings to your needs, so your data is fully protected.



CONVENIENT

A range of print, scan and copy functions ensures that your office needs are met quickly and with no fuss. Get things done when you want, in the format you want.

High-performance Hardware for a Stress-free Work Environment

With a quad-core CPU and 4GB of memory at your disposal, the 306i series is ready to deliver high performance at a moment's notice. And if that's not enough, add the high-speed SSD package for timely data retrieval at any time.

High-speed SSD

The new generation of bizhub adopts SSD (solid state drive) storage, allowing you to access data faster and with less risk, as SSD storage is less prone to faults than older HDD technology.

SSD is optional



High-speed Automatic Document Feeder

Scan up to 55 pages per minute in both colour and black and white with the newly-improved high-speed automatic document feeder. Load up to 130 sheets at one time and scan in high-quality colour to a variety of document formats.

Electronic Correction for Scanned Images

When large volumes of paper are scanned with the automatic document feeder, documents are sometimes scanned on a slight angle, making printed copies or digital versions difficult to read. With Konica Minolta's automatic electronic correction, documents are electronically corrected after scanning, ensuring all your copies and scans are just as good as the original.



Scan to a Variety of Formats

Scan documents directly into the format you need to save time changing file formats later.

Transform Scanned Documents to Editable PowerPoint Files

Scan documents directly to PPTX format to enable you to open and edit the document in Office PowerPoint (Office 2007 or later).

Compatible with Compact PDF

You can now scan to Compact PDF, a compressed format that saves a significant amount of space over conventional PDF files, while improving image quality. What's more, thanks to the high-speed CPU, processing time is reduced.

Print from & Scan to Your Mobile Devices

Cut out the fuss of transferring files between devices by accessing your bizhub directly from a variety of mobile devices. Find a mobile option to suit your personal workstyle with tap-to-print from our in-house print app, or cover a wider variety of printers with the Mopria app.

Konica Minolta Mobile Print



Print and scan wirelessly from your mobile devices by downloading our app. Use bluetooth or the NFC to authenticate your device, then send print jobs and receive scan data via Wi-Fi.

*Optional device connection I/F kit EK-613. Bluetooth LE (low energy) interface required for iOS devices. Wireless LAN environment required. Konica Minolta Mobile Print is available free from the App Store for iOS devices and the Google play for Android devices.

Mopria Certified



Send and receive data to your bizhub via the Mopria app on Android. The Mopria Alliance certifies printers and MFPs from many brands for use via their app, making it easy to print from, and scan to, your mobile devices, even if this is the first Konica Minolta machine to join your workspace network.

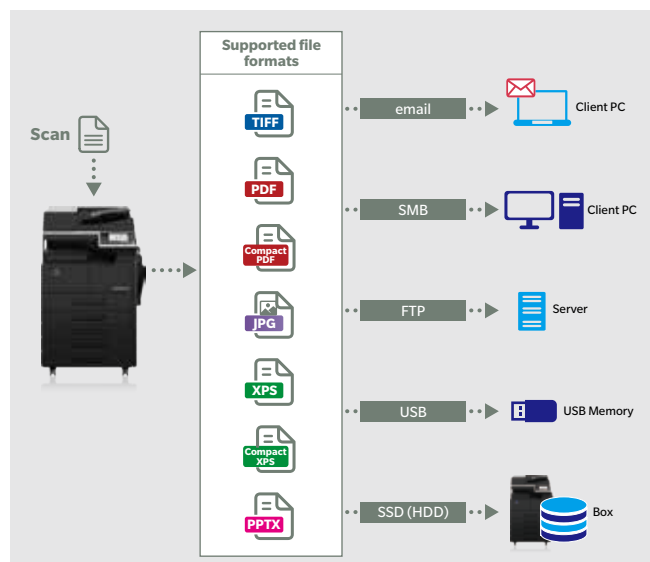



Speed Up Your Workflow

Browse the Web

Display websites on the control panel and print them via PDF. Specify parts of a page and get precise print outs of only the things you need, such as maps or selected information.



Customise your bizhub via IWS

With Konica Minolta's IWS (Internal Web Server) technology, you can now completely reconfigure the control panel of your bizhub to tailor it to your needs. Combining a web server, web browser and script interpreter, IWS can be used to implement simplified user interfaces or widget-style applications.

USB Direct Print and Scan

Connect a USB memory device and access files on the touch panel. Select files for print, or scan documents directly to the device.

Supported file formats: TIFF, PDF, Compact PDF, JPEG, XPS, Compact XPS, PPTX

Add Functionality to Your bizhub with MarketPlace

MarketPlace is now pre-installed, ready for use upon setup. Browse to find apps that enhance and personalise your bizhub's functionality the same way you would with your smart devices.



Picture for illustration purpose only



Print Driver to Support High-quality Images

Your bizhub comes with a PCL/PS print driver as standard, enabling high image quality and high-speed data transfer when printing. The print driver is equipped with an automatic trapping function that corrects colour shifting when printing text, so every document you print achieves a beautiful finish.



Variety of Basic Print and Copy Features

Booklet Print

A convenient feature which collates multiple pages into one booklet.



N-up Print (2-in-1 or 4-in-1)

Print multi-page documents onto one sheet. Combine either 2 or 4 pages into one.

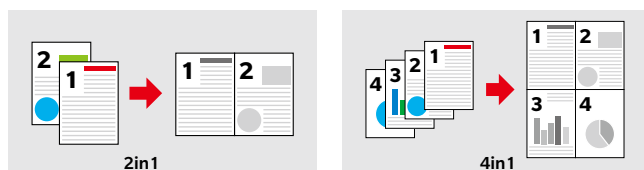

ID Copy

Small or irregularly shaped documents, such as employee ID cards or licenses, can be printed with the front and back sides combined onto one sheet.

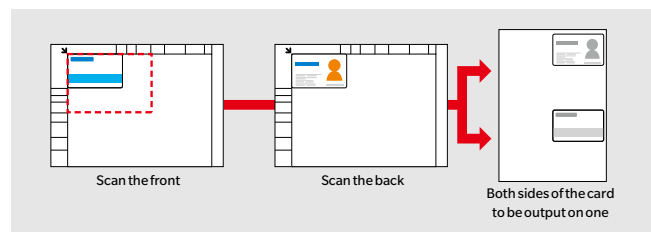

Duplex Print or Copy

Duplex Print enables double-sided printing, helping you to save paper.

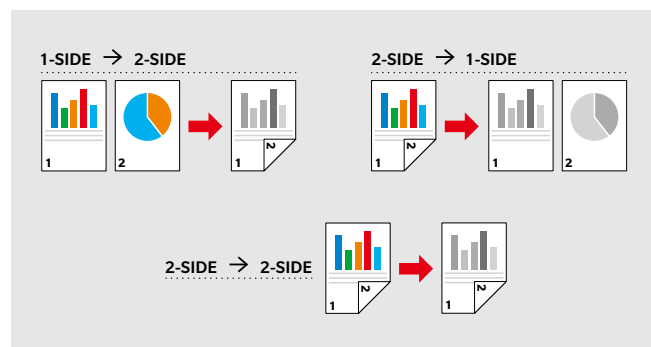

Environmentally Friendly

Environmental friendliness and sustainability are important to Konica Minolta. Our toners are free of titanium-dioxide, and fuses at lower temperature reducing energy consumption.



KONICA MINOLTA

bizhub 306i/266i

Option Diagram

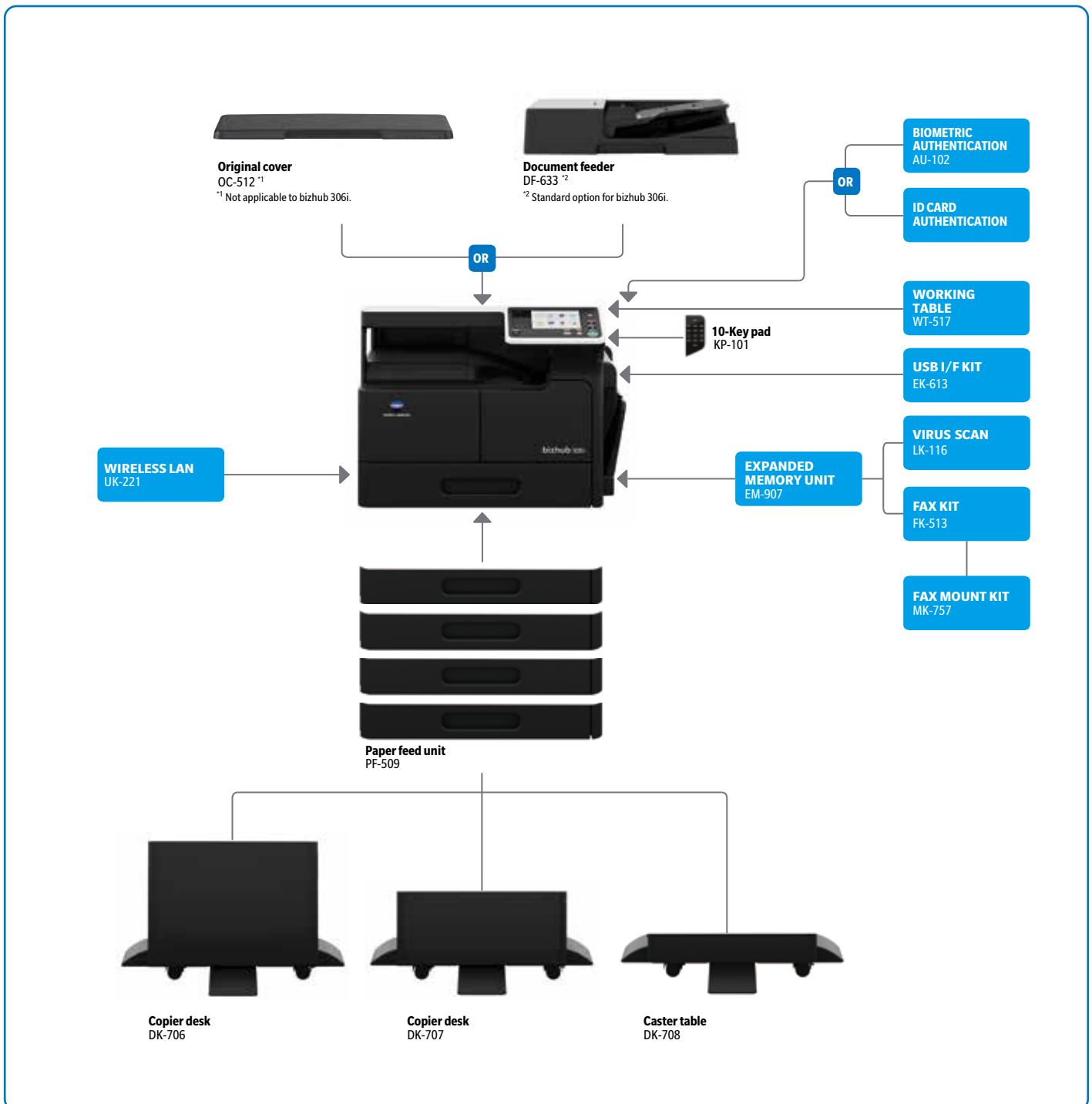

Finishing functionalities

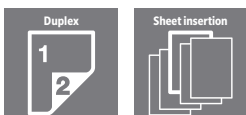

System Overview	
System memory	4GB
System SSD (optional)	256 GB SSD
Interface	10-BASE-T/100-BASE-TX/1,000-BASE-T Ethernet, USB 1.1, USB 2.0, Wi-Fi 802.11a/b/g/n/ac (optional)
Network protocols	TCP/IP (IPv4/IPv6), NetBEUI, SMB, LPD, IPP, SNMP, HTTP
Automatic document feeder*	Up to 130 originals, A5-A3, 35-128 gsm *306i: standard, 266i: optional
Printable paper size	A6-A3, customised paper sizes
Printable paper weight	64-157 gsm
Paper input capacity	Standard: 350 sheets, Max.: 1,350 sheets
Tray 1	250 sheets, A6-A3, custom sizes, 64-157 gsm
Tray 2 to 5 PF-509 (optional)	up to 4x250 sheets, B5-A3, 64-90 gsm
Bypass tray	up to 100 sheets, A6-A3, custom sizes, 64-157 gsm
Automatic duplexing	A5-A3, 64-90 gsm
Power consumption	[220-240 V, 50/60 Hz] less than 1522W (system)
System dimensions	306i: [W x D x H] 627 x 622 x 579.6 mm (24.7 x 24.5 x 22.8 inch) ^{*1} 266i: [W x D x H] 627 x 615 x 458 mm (24.7 x 24.2 x 18.0 inch) ^{*2}
System weight ^{*3}	306i: Approx. 37.5 kg(82.7 lb) 266i: Approx. 32 kg(70.5 lb)

^{*1} Excluding lower paper tray unit

^{*2} Excluding ADF and lower paper tray unit

^{*3} Including toner bottle

Copier Specifications	
Copying process	Electrostatic laser copy, intermediate
Toner system	Simitri® HD Polymerized Toner
Copy/print speed A4	306i: Up to 30 ppm, 266i: Up to 26 ppm,
1st copy out time	5.0 sec. or less
Warm-up time	13 sec. or less
Copy resolution	600 x 600 dpi
Gradation	256 gradations
Multicopy	1-9,999
Original format	A5-A3
Magnification	25-400% in 0.1% steps, auto-zooming

Printer Specifications	
Print resolution	600 (equivalent) x 600 dpi
Page Description Language	PostScript 3 (3016) Emulation, PCL 6 (XL Version 3.0) Emulation, PCL 5e/c Emulation, XPS
Operating systems	Windows 10 (32/64), Windows Server 11 (32/64), Windows Server 2016, Windows Server 2022, macOS X 10.16 or later, Linux, Unix, Citrix
Printer fonts	80 PCL, 137 PostScript 3 Emulation
Mobile printing	AirPrint (iOS), Mopria (Android), Konica Minolta Mobile Print (iOS, Android), WiFi Direct

Scanner Specifications	
Scan speed ^{*4} with DF-633 (optional)	1-sided original: 30 ipm (600 dpi), 55 ipm (300 dpi) 2-sided original: 15 ipm (600 dpi), 22 ipm (300 dpi)
Resolution	Max.: 600 x 600 dpi
Scan modes	Scan-to-email (Scan-to-Me); Scan-to-SMB (Scan-to-Home); Scan-to-FTP; Scan-to-USB; Scan-to-WebDAV; Scan to BOX (SSD) ^{*5} ; Scan to WSD (Web Service); Scan to DPWS (Device Profile for Web Service); Network TWAIN scan ^{*5}
File formats	TIFF, PDF, Compact PDF, JPEG, XPS, Compact XPS, OOXML (pptx)
Destinations	2,100 (single + group), LDAP, DA support

^{*4} When copying A4 or Letter (8-1/2 x 11)

^{*5} Optional

Fax Specifications (optional)	
Fax	Super G3
Transmission	Analog fax, Internet fax, Colour Internet fax, IP address fax
Resolution	Max.: 600 x 600 dpi (ultra-fine)
Compression method	MH, MR, MMR, JBIG
Modem speed	Up to 33.6 Kbps
Destinations	2,100 (single + group)

Components and Options	
DK-706 Copier desk	Provides storage space for print media and other materials Install with 1x PF-509
DK-707 Copier desk	Provides storage space for print media and other materials Install with 2x PF-509
DK-708 Caster table	Used to install this machine on the floor Install with 4x PF-509
KP-101 10-Key pad	10-key number pad
DF-633 Document feeder	Reverse automatic document feeder, capacity 130 originals
OC-512 Original cover	Cover instead of ADF
WT-517 Working table	Authentication device placement
FK-513 Fax board	Super G3 fax
MK-757 Fax mount kit	Mount kit for FK-513
LK-116 Antivirus	Bitdefender Antivirus provides real time scanning of all incoming/outgoing data
EM-907 Expanded memory unit	256GB SSD
EK-613 USB I/F kit	USB interface kit, Bluetooth LE
ID card authentication	Various ID card technologies
AU-102 Biometric authentication	Finger vein scanner
UK-221 Wireless LAN	Wireless LAN and wireless LAN Access Point Mode

¹ Warm-up time may vary depending on the operating environment and usage

² If the maximum volume is reached within a period of one year, then a maintenance cycle must be performed

– All specifications refer to A4-size paper of 80 g/m² quality.

– The support and availability of the listed specifications and functionalities varies depending on operating

Simitri HD
High Definition Polymerized Toner



Konica Minolta Business Solutions Asia Pte Ltd

21 Media Circle
#08-01 Infinite Studios
Singapore 138562
Tel: +65 6563 5533
Fax: +65 6561 9879
Email: sales@konicaminolta.sg
www.konicaminolta.com

PRESENCE IN THE REGION

BANGLADESH . BRUNEI . CAMBODIA . INDONESIA . LAOS . MALAYSIA . MAURITIUS . MYANMAR . PHILIPPINES . SINGAPORE . SRI LANKA . THAILAND . VIETNAM

Our organisation is certified according to ISO27001, ISO9001 and ISO14001 standards.



Please scan for more information on
the bizhub 306i/266i