



KONICA MINOLTA

**bizhub 4221i**  
A4 Monochrome All-In-One

**bizhub 4201i**  
A4 Monochrome Printer

# **bizhub** **i-SERIES**

**RETHINK IT**

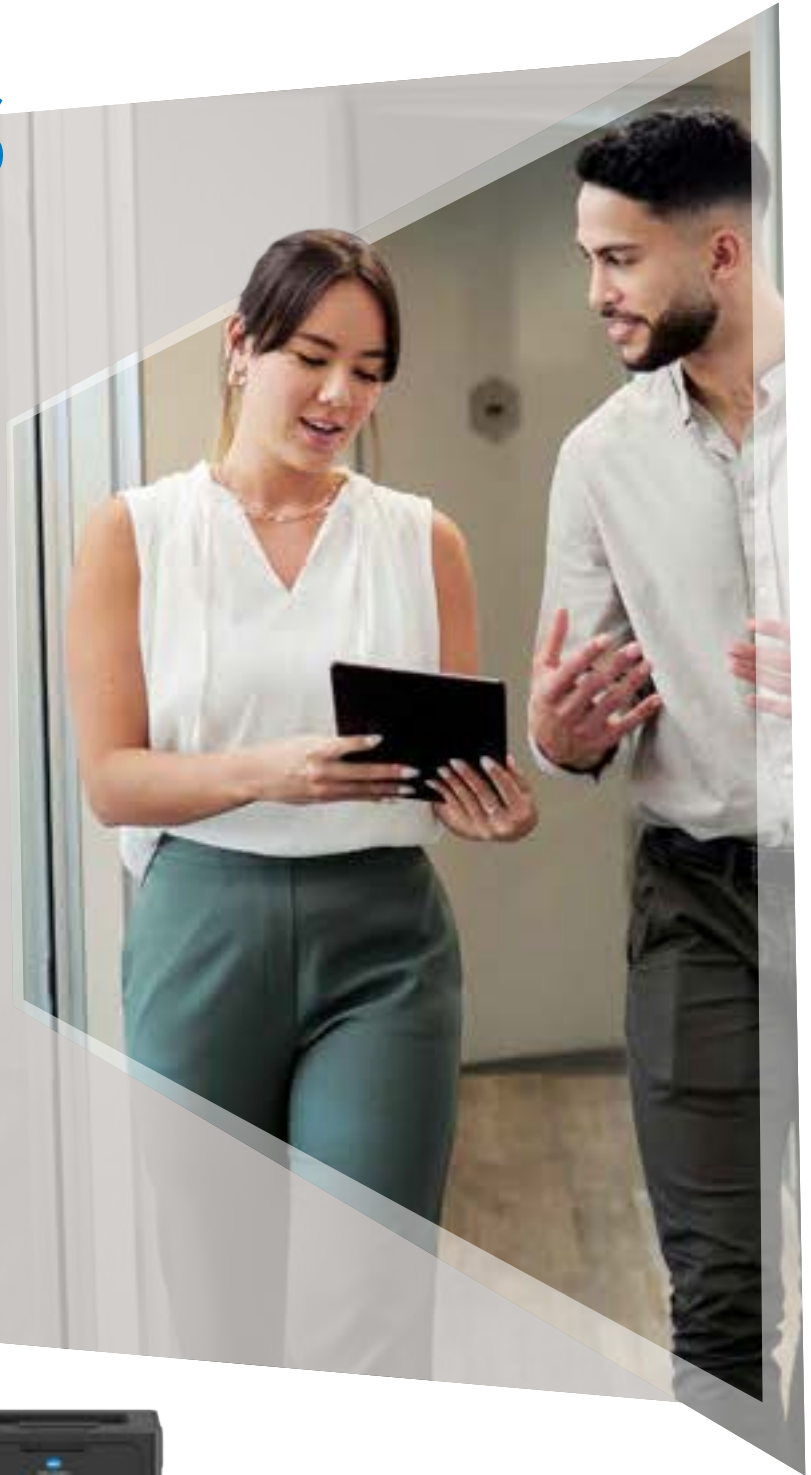

**4221i**  
BW 42 PPM



**4201i**  
BW 42 PPM

Giving Shape to Ideas

# USER BENEFITS

A machine that knows you. Intuitive design and simple operation.

## Easy to Use, Intuitive Control Panel

4221i 4201i

The large colour LCD touch panel is easy to operate even for first-time users. An intuitive interface and smartphone-like operability helps you get to the functions you need quickly, with no fuss.



bizhub 4221i 3.5-inch touch

## Keep It Simple

4221i 4201i

The more compact 4201i models feature screens that clearly display settings information and enhance usability with intuitive controls. The bizhub 4201i comes with a straightforward LCD screen ideal for basic display needs.

## Easy Access

4221i 4201i

Frontal access to the paper tray and toner cartridge allows your bizhub to be placed anywhere, even if it's a crowded location.

## Wireless Connectivity

4221i 4201i

Fed up with cables and wires getting in the way and restricting where you can place your printer in the office? All models are equipped to operate wirelessly. Place your machine wherever is convenient, and print from anywhere inside your office via your Wi-Fi network.

## Get Started Faster

4221i 4201i

Get to work in 27 seconds or less. All models have an outstanding warm-up time, helping you to get on with what matters.

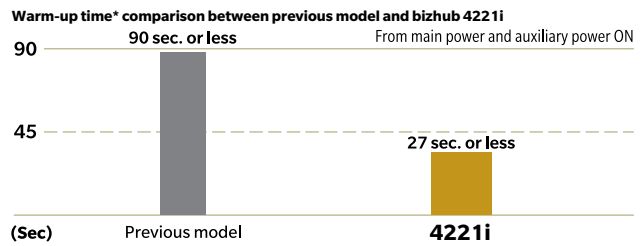

\* 23°C, at rated voltage

## A Small Footprint

4221i 4201i

Whether you are adding to your existing fleet of devices or looking for a single workhorse, having a machine small enough to place on a desktop or any convenient surface is a huge benefit.



# COPY & PRINT

A range of useful functions available at your fingertips.

## Reliable High-Speed Printing

4221i 4201i

Print up to 42 pages per minute with the bizhub 4221i and 4201i models. Outstanding durability and low maintenance needs are combined with great quality and high speed, so you can keep printing all day long.

## Add Paper Storage Capacity Up to 1,660 Sheets

4221i 4201i

Add to the standard paper capacity with additional feeder units to build the machine that best suits your working environment. Boost your bizhub by up to 1,040 sheets with the PF-P24 and PF-P23 optional units.

The 4221i model can accommodate up to 1,390 sheets maximum.

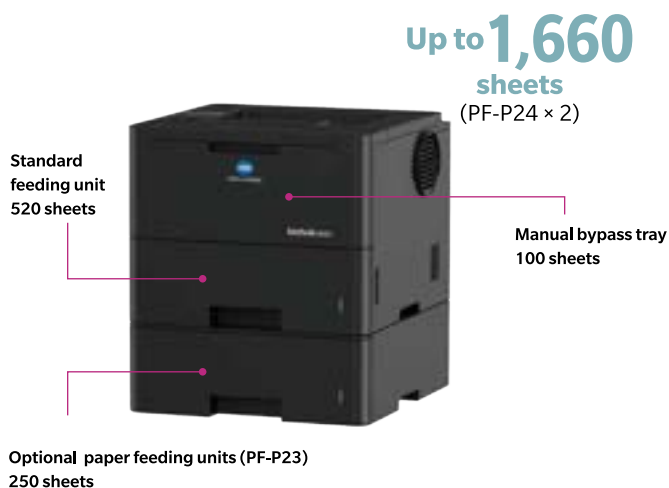

## Copy with Clarity

4221i 4201i

Copy quality has been significantly improved over previous bizhub models. Scan up to 1,200 dpi using the Document Glass to achieve detailed replication when copying and scanning.

## Choose the Ideal Layout

4221i 4201i

A variety of layout options and double-sided printing help optimize your printed materials and save paper. Combine multiple pages or images onto one sheet when copying and printing. Consolidate up to 4 pages into one when copying at your AIO, or up to 16 pages into one when printing.

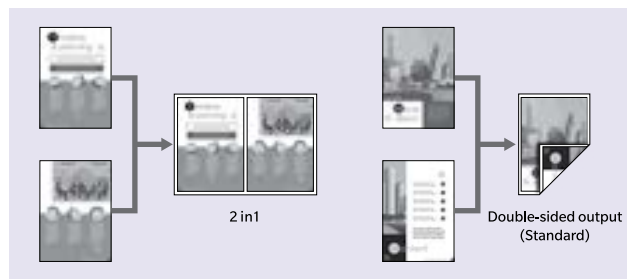

## ID Copy

4221i 4201i

Use the ID Copy function on the 4221i models to scan ID cards or other small or irregularly shaped documents and combine both scans cleanly onto a single sheet.

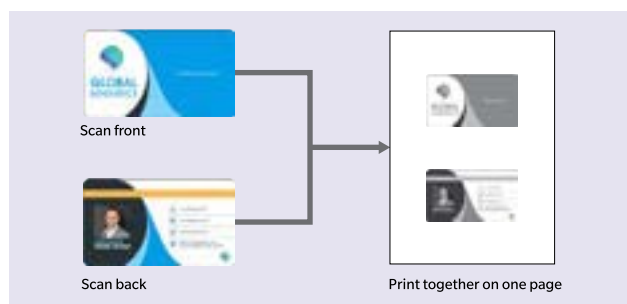

## Print from USB

4221i 4201i

Data stored on a USB memory device can be printed directly from your bizhub using the USB port on the front panel. Print from a variety of formats including DOCX, PPTX, XLSX (all part of the Office Open XML format), as well as PDF, JPEG, PNG and TIFF.

# SCAN & FAX

High-quality and high-speed capability. Treat your documents right.

## Efficient Double-Sided Scanning for Every Workflow

4221i 4201i

The bizhub 4221i offer fast, double-sided scanning for both colour and black-and-white documents. With a high-capacity feeder that handles up to 50 sheets at once.



Model	Colour (Simplex)	B/W (Simplex)	Colour (Duplex)	B/W (Duplex)
bizhub 4221i	Up to 20 ppm	Up to 28 ppm	Up to 40 ppm	Up to 56 ppm

## Scan to Editable and Searchable Files

4221i 4201i

The iPrint&Scan and Mopria Scan enable users to scan documents directly from their bizhub device to a PC or mobile device. Files can be saved, shared, or processed with OCR software to create editable text or searchable PDFs. TWAIN and WIA support ensure compatibility with a wide range of applications.

## Paperless Sharing

4221i 4201i

Scan documents to a range of formats and share them in the way that's best for you.

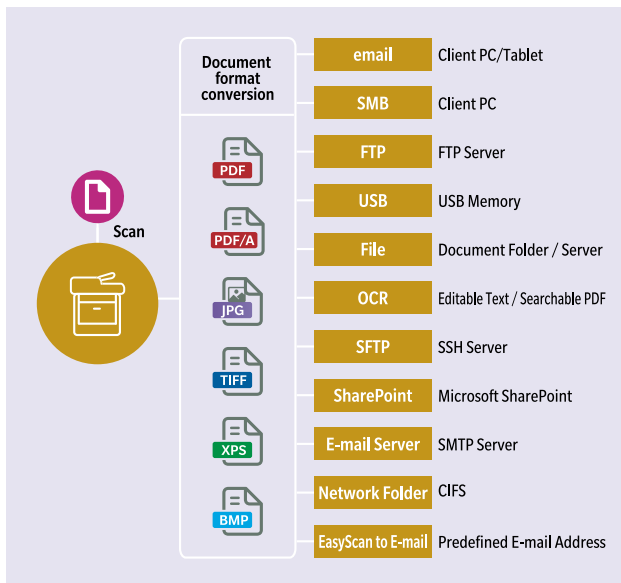

## Smooth Document Handling with iPrint&Scan

4221i 4201i

Ideal for everyday office tasks, iPrint&Scan let users easily scan and print from their bizhub device using a PC. Instead of navigating the control panel, users can access essential functions such as scanning and saving documents directly through the software. This makes workflows faster and more intuitive.

## High Security Super G3 Fax

4221i 4201i

The bizhub 4221i models are equipped with high-speed Super G3 faxing, ensuring you are well equipped for any situation. If your bizhub receives a new fax when out of paper, the fax is saved securely until paper is available. What's more, with Secure Transmission, you can confirm your faxes are transmitted without error with the use of VoIP. All-round performance in a compact machine.



# MOBILE & CLOUD

Access your bizhub via your mobile device for a seamless work life.

## Konica Minolta Mobile Print

4221i 4201i

Print and scan with your smartphone or tablet. The Konica Minolta Mobile Print app is fast, secure and convenient. Use your bizhub directly from Android and Apple devices via your office Wi-Fi.\*

\* Download Konica Minolta Mobile Print App from Google Play Store or App Store.

## Mobile Printing with Mopria Print Service and AirPrint

You can print wirelessly from mobile devices using Mopria Print Service for Android devices and AirPrint for iOS devices, without installing a print driver.

4221i 4201i

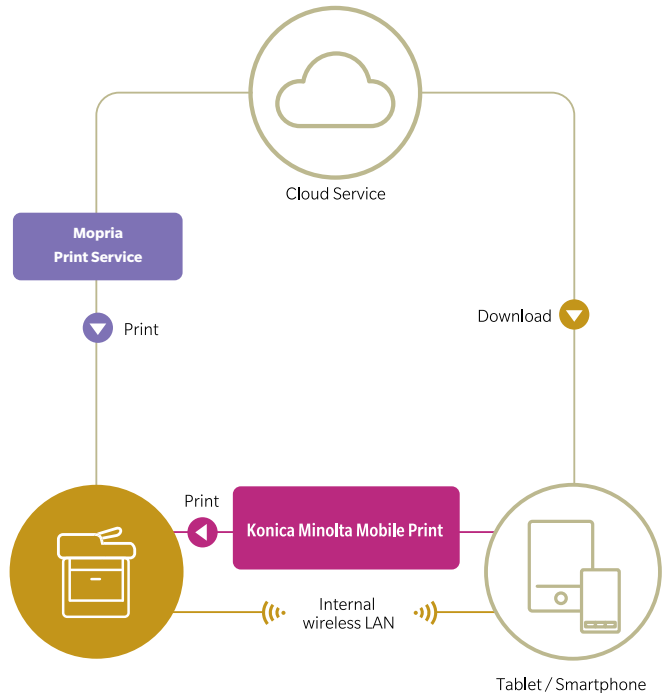
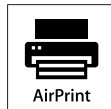

# SECURITY

Keep your office environment secure and keep your documents private.

## Secure Print

4221i 4201i

User will set a password prior to sending print. The same password has to be keyed to the control panel to release the print. This prevents confidential documents from lying around the office or being accessed by unauthorized users.

## Function Lock

4221i 4201i

This setting requires each user to have a password and allows the administrator to enable or disable functions for different users, preventing unauthorized users from gaining access. You can also set the maximum volume of printing each user is allowed to do via the machine, helping you stay in control of paper usage.

# ENVIRONMENT

Look after our global environment and your office space.

## Energy-saving Design

4221i 4201i

This environmentally conscious product complies to international environmental standards, including ENERGY STAR (US) for energy efficiency, the Green Purchasing Law and Eco Mark (Japan) for promoting sustainable procurement, and the RoHS Directive (EU) for restricting the use of hazardous substances.

## Easily Balance Your Consumption

4221i 4201i

With a wealth of economy measures, you can balance quality and ecological performance as you need. Toner Economy Mode reduces the amount of toner used without sacrificing legibility, helping to save on toner usage. Deep Sleep Mode consumes less power than conventional Sleep Mode, and the printer will still reactivate as soon as new print data is received. The LCD panels on the bizhub 4221i model are also auto-dimming, saving energy when the machine is not in use.

## OPTIONS

### 1 MEDIA INPUT

Paper tray

PF-P23

x2

OR

Paper tray

PF-P24

x2

#### LEGEND

- Mandatory option
- Option
- This option can only be installed with the respective option above it



**bizhub 4201i**

## DESCRIPTION

### MEDIA INPUT

PF-P23 Paper tray	250 sheets; A4; 60-120 g/m <sup>2</sup>
PF-P24 Paper tray	520 sheets; A4; 60-120 g/m <sup>2</sup>

## TECHNICAL SPECIFICATIONS

### SYSTEM SPECIFICATIONS

System speed A4	Up to 42 ppm
Autoduplex speed A4	Up to 20 ppm
1st page out time A4	7.2 sec.
Warm-up time	Approx. 25 sec. <sup>1</sup>
Imaging technology	Laser (Class 1 laser product)
Toner technology	Polymerized Toner
Panel size/resolution	1 line LCD
CPU	Cortex-A53 1.2GHz Dual Core
System memory	256 MB (standard/max)
Interface	10/100/1,000-Base-T Ethernet; USB 2.0; Wi-Fi 802.11 b/g/n/ac
Network protocols	TCP/IP (IPv4 / IPv6); LPD; IPP; SNMP; HTTP; HTTP(S)
Printable paper size	A6-A4; customized paper sizes
Printable paper weight	60-230 g/m <sup>2</sup>
Paper input capacity	620 sheets / 1,660 sheets (standard/max)
Paper tray input (standard)	1x 520; A6-A4; 60-163 g/m <sup>2</sup>
Paper tray input (optional)	1x 250 sheets; A5-A4; 60-120 g/m <sup>2</sup> (up to 2x) 1x 520 sheets; A5-A4; 60-120 g/m <sup>2</sup> (up to 2x)
Manual bypass	100 sheets; A6-A4; custom sizes; 60-230 g/m <sup>2</sup>
Automatic duplexing	A4; 60-105 g/m <sup>2</sup>
Output capacity	Up to 150 sheets
Duty cycle (monthly)	Rec. 5,000 pages; Max. <sup>2</sup> 100,000 pages
Toner lifetime	Black up to 11,000 pages
Imaging unit lifetime	Black up to 75,000 pages (3 pages/job)
Power consumption	220-240 V / 50/60 Hz; Less than 640 W
System dimension (W x D x H)	373 x 388 x 289 mm (without options)
System weight	Approx. 12.3 kg (without options)

### PRINTER SPECIFICATIONS

Print resolution	1200 x 1200 dpi
Page description language	PCL 6 (XL3.0); PostScript 3; XPS; PDF 1.7
Operating systems	Windows 10/11 (32/64); Windows Server 2012/2016/2019/2022/2025; macOS 11.x - 15.x; Linux; iOS; Android
Printer fonts	85 PCL Latin; 66 PostScript 3 Emulation Latin; 1D & 2D barcodes; QR Codes
Mobile printing	Mopria (Android); Konica Minolta Print Service (Android); Konica Minolta Mobile Print (iOS/Android); WiFi Direct; AirPrint; Google ChromeOS; Universal Print

### SYSTEM FEATURES

Security	SSL2; SSL3 and TLS1.0/1.1/1.2 network communication; IPsec support; IEEE 802.1x support; Secure print; Kerberos; SNMPv3; LDAP authentication
Accounting	Active Directory support (user name + password + e-mail + smb folder); User Function Access Definition optional: ID card authentication (ID card reader)
Software	Driver Packaging Utility Download Manager

## OPTIONS

### 1 MEDIA INPUT

Paper tray  
PF-P23

x2

OR

Paper tray  
PF-P24

x2

#### LEGEND

- Mandatory option
- Option
- This option can only be installed with the respective option above it

## DESCRIPTION

### MEDIA INPUT

PF-P23 Paper tray	250 sheets; A4; 60-120 g/m <sup>2</sup>
PF-P24 Paper tray	520 sheets; A4; 60-120 g/m <sup>2</sup>



**bizhub 4221i**

## TECHNICAL SPECIFICATIONS

### SYSTEM SPECIFICATIONS

System speed A4	Up to 42 ppm
Autoduplex speed A4	Up to 20 ppm
1st page out time A4	9.2 sec.
Warm-up time	Approx. 27 sec. <sup>1</sup>
Imaging technology	Laser (Class 1 laser product)
Toner technology	Polymerized Toner
Panel size/resolution	3.5" / 432 x 240
CPU	Cortex-A53 1.2GHz Dual Core
System memory	512 MB (standard/max)
Interface	10/100/1,000-Base-T Ethernet; USB 2.0; Wi-Fi 802.11 b/g/n/ac
Network protocols	TCP/IP (IPv4 / IPv6); LPD; IPP; SNMP; HTTP; HTTPS
Automatic document feeder	Up to 50 originals; A6-A4; 64-90 g/m <sup>2</sup> ; Dual Scan ADF
Printable paper size	A6-A4; customized paper sizes
Printable paper weight	60-230 g/m <sup>2</sup>
Paper input capacity	350 sheets / 1,390 sheets (standard/max)
Paper tray input (standard)	1x 250; A6-A4; 60-163 g/m <sup>2</sup>
Paper tray input (optional)	1x 250 sheets; A5-A4; 60-120 g/m <sup>2</sup> (up to 2x) 1x 520 sheets; A5-A4; 60-120 g/m <sup>2</sup> (up to 2x)
Manual bypass	100 sheets; A6-A4; custom sizes; 60-230 g/m <sup>2</sup>
Automatic duplexing	A4; 60-105 g/m <sup>2</sup>
Output capacity	Up to 150 sheets
Duty cycle (monthly)	Rec. 5,000 pages; Max. <sup>2</sup> 100,000 pages
Toner lifetime	Black up to 11,000 pages
Imaging unit lifetime	Black up to 75,000 pages (3 pages/job)
Power consumption	220-240 V / 50/60 Hz; Less than 640 W
System dimension (W x D x H)	417 x 461 x 448 mm (without options)
System weight	Approx. 16.4 kg (without options)

### PRINTER SPECIFICATIONS

Print resolution	1200 x 1200 dpi
Page description language	PCL 6 (XL3.0); PostScript 3; XPS; PDF 1.7
Operating systems	Windows 10/11 (32/64); Windows Server 2012/2016/2019/2022/2025; macOS 11.x - 15.x; Linux; iOS; Android
Printer fonts	85 PCL Latin; 66 PostScript 3 Emulation Latin; 1D & 2D barcodes; QR Codes
Mobile printing	Mopria (Android); Konica Minolta Print Service (Android); Konica Minolta Mobile Print (iOS/Android); WiFi Direct; AirPrint; Google ChromeOS; Universal Print

### SCANNER SPECIFICATIONS

Scan speed	Up to 28/20 ipm in simplex (mono/colour) Up to 56/40 ipm in duplex (mono/colour)
Scan resolution	Up to 1,200 x 1,200 dpi
Scan modes	Scan-to-eMail (Scan-to-Me); Scan-to-FTP; Scan-to-USB; Scan-to-File; TWAIN scan; WIA scan; Scan-to-SFTP; Scan-to-DPWS
File formats	JPEG; TIFF; PDF; XPS; PDF/A; BMP
Scan destinations	LDAP support

### COPIER SPECIFICATIONS

Copy resolution	600 x 600 dpi
Gradation	256 gradations
Multicopy	1-999
Original format	Max. A4
Magnification	25-400% in 1.0% steps; Auto-zooming

### FAX SPECIFICATIONS

Fax standard	Super G3
Fax transmission	Analogue; i-Fax
Fax compression	MH; MR; MMR; JBIG
Fax modem	Up to 33.6 Kbps
Fax destinations	299 destinations + 20 groups

### SYSTEM FEATURES

Security	SSL2; SSL3 and TLS1.0/1.1/1.2 network communication; IPsec support; IEEE 802.1x support; Secure print; Kerberos; SNMPv3; LDAP authentication
Accounting	Active Directory support (user name + password + e-mail + smb folder); User Function Access Definition optional: ID card authentication (ID card reader)
Software	Driver Packaging Utility Download Manager

## FINISHING FUNCTIONALITIES



**Duplex**

## CUSTOMER BENEFITS



### Mobile connectivity

Print anytime from anywhere with Konica Minolta's innovative mobile technologies



### Services

Efficient printer fleet management, including automatic consumables delivery, pro-active maintenance and remote setup

<sup>1</sup> Warm-up time may vary depending on the operating environment and configuration

<sup>2</sup> If the maximum volume is reached within a period of one year, then a maintenance cycle must be performed

- All specifications refer to A4-size paper of 80 g/m<sup>2</sup> quality.
- The support and availability of the listed specifications and functionalities varies depending on operating systems, applications and network protocols as well as network and system configurations.
- The stated life expectancy of each consumable is based on specific operating conditions such as page coverage for a particular page size (6% coverage of A4). The actual life of each consumable will vary depending on use and other printing variables including page coverage, page size, media type, continuous or intermittent printing, ambient temperature and humidity.
- Some of the product illustrations contain optional accessories.
- Specifications and accessories are based on the information available at the time of printing and are subject to change without notice.
- Konica Minolta does not warrant that any specifications mentioned will be error-free.
- All brand and product names may be registered trademarks or trademarks of their respective holders and are hereby acknowledged.

# bizhub 4221i / 4201i



### Konica Minolta Business Solutions Asia Pte Ltd

21 Media Circle

#08-01 Infinite Studios

Singapore 138562

Tel: +65 6563 5533

Email: sales@konicaminolta.sg

www.konicaminolta.com

### PRESENCE IN THE REGION

BANGLADESH . BRUNEI . CAMBODIA . INDONESIA . LAOS . MALAYSIA . MAURITIUS . MYANMAR . PHILIPPINES . SINGAPORE . SRI LANKA . THAILAND . VIETNAM

Our organisation is certified according to ISO27001, ISO9001 and ISO14001 standards.